



MAC Stationary Compactors

Stationary Compactors

MAC Corporation's high quality stationary compactors are designed and engineered to efficiently and economically handle maximum loads and stresses in commercial and medium industrial applications. Our compactors can be configured for your specific needs with custom fitted side or rear load hoppers, security chutes, drive on decks, loading dock enclosures and other optional equipment.



MAC Corporation compactors are constructed of quality AISI grade steel, built to exacting specifications, and designed for years of rugged dependable service.

Standard Features

NEMA 12 Remote Control Station on 13 ft Sealtite	Side Mounted Power Unit	Key-lock Start Switch
Power Unit Weather Cover	Red Mushroom-head Stop Button	NEMA 12/13 Control Panel
Power Unit Factory Ready for 208-230-460 Volt 3 phase	Solid State Motor Starter Overload. Adjustable 9-45 Amp	Automatic Motor Starter Reset

Contact:
sales@crarent.com
service@crarent.com



Give us a call
(855) 898-4811

CRARENT.COM





Contact:
sales@crarent.com
service@crarent.com



Give us a call
(855) 898-4811

CRARENT.COM



Specifications and Dimensions - Stationary Compactors

	MAC 200	MAC 300	MAC 400
Mfr. Rating	2 cubic yards	3 cubic yards	4 cubic yards
Industry Rating	1.58 cubic yards	2.55 cubic yards	3.17 cubic yards
Clear Top Opening	58" x 42-1/2"	58" x 67-1/2"	58" x 79-1/2"
Hydraulic Cylinders	6" bore x 55.5" stroke x 4" rod	6" bore x 81" stroke x 42" rod	6" bore x 96" stroke x 4" rod
Ram Penetration	12.5"	13"	16"
Packing Force	Normal: 46,700 lbs. Maximum: 55,100 lbs.	Normal: 46,700 lbs. Maximum: 55,100 lbs.	Normal: 48,100 lbs. Maximum: 56,500 lbs.
Ram Face PSI	Normal: 27.3 PSI Maximum: 32.2 PSI	Normal: 27.3 PSI Maximum: 32.2 PSI	Normal: 28.2 PSI Maximum: 33 PSI
Hydraulic Pressure	Normal: 1650 PSI Maximum: 1950 PSI	Normal: 1650 PSI Maximum: 1950 PSI	Normal: 1700 PSI Maximum: 2000 PSI
Ram Face Dimensions	28.5" x 60"	28.5" x 60"	28.5" x 60"
Cycle Time	50 seconds	47 seconds	58 seconds
Motor	10 H.P. TEFC	15 H.P. TEFC	15 H.P. TEFC
Pump	11.5 GPM vane	17.5 GPM vane	17.5 GPM vane
Weight	4,600 lbs.	5,850 lbs.	7,850 lbs.
Frame Floor	3/8" plate	3/8" plate	1/2" plate
Frame Sides	3/16" plate	3/16" plate	3/16" plate
Breaker Bar	8" x 6" x 3/4" angle	8" x 6" x 3/4" angle	8" x 6" x 3/4" angle
Ram Face	3/4" plate	3/4" plate	3/4" plate
Ram Floor	3/8" T1 plate	3/8" T1 plate	3/8" T1 plate
Ram Top	1/4" plate	1/4" plate	1/4" plate
Ram Sides	1/4" plate	1/4" plate	1/4" plate
Ram Guides	UHMWPE	UHMWPE	UHMWPE

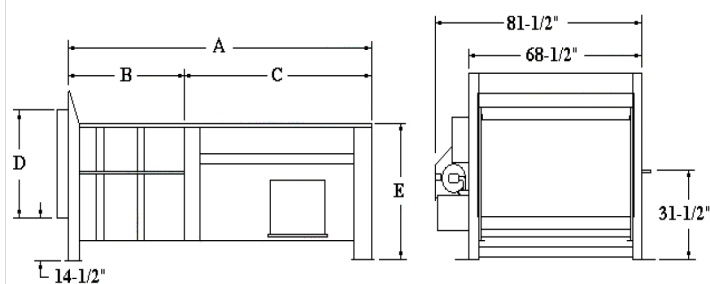

Dimensions	MAC 200	MAC 300	MAC 400
A	119-1/2"	173-3/4"	201-1/4"
B	44-1/2"	70"	82"
C	74"	103"	118-1/2"
D	38-1/4"	38-1/4"	38-1/4"
E	48"	48"	48"